

# M-Series Pushbutton Switches

**Approvals:**

Pending

**Contact Rating**

10A 125/250 VAC

1/4 HP 125 VAC

10A 14 VDC

**Contact Material**

Fine Silver

**Dielectric Strength**

2000 VAC RMS

**Life**

25,000 operations at max. rating - 100,000 mechanical

**Terminals**

3/16" quick-connect or .050 x .031 p.c.

**Lamps**

6, 12 and 28 volt incandescent lamps.

125 and 250 volt neon lamps.

6 or 12 volt LED's.

Circuit	Switching	Circuit Diagram (Lighted)	Circuit Diagram (Non-Lighted)
1	Single-Pole Single-Throw Normally Open		
3	Double-Pole Single-Throw Normally Open	N/A	
6	Single-Pole Single-Throw Normally Open		N/A
7	Double-Pole Single-Throw Normally Open		N/A
D	Indicator Light Only		N/A

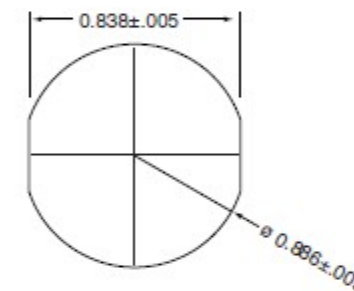
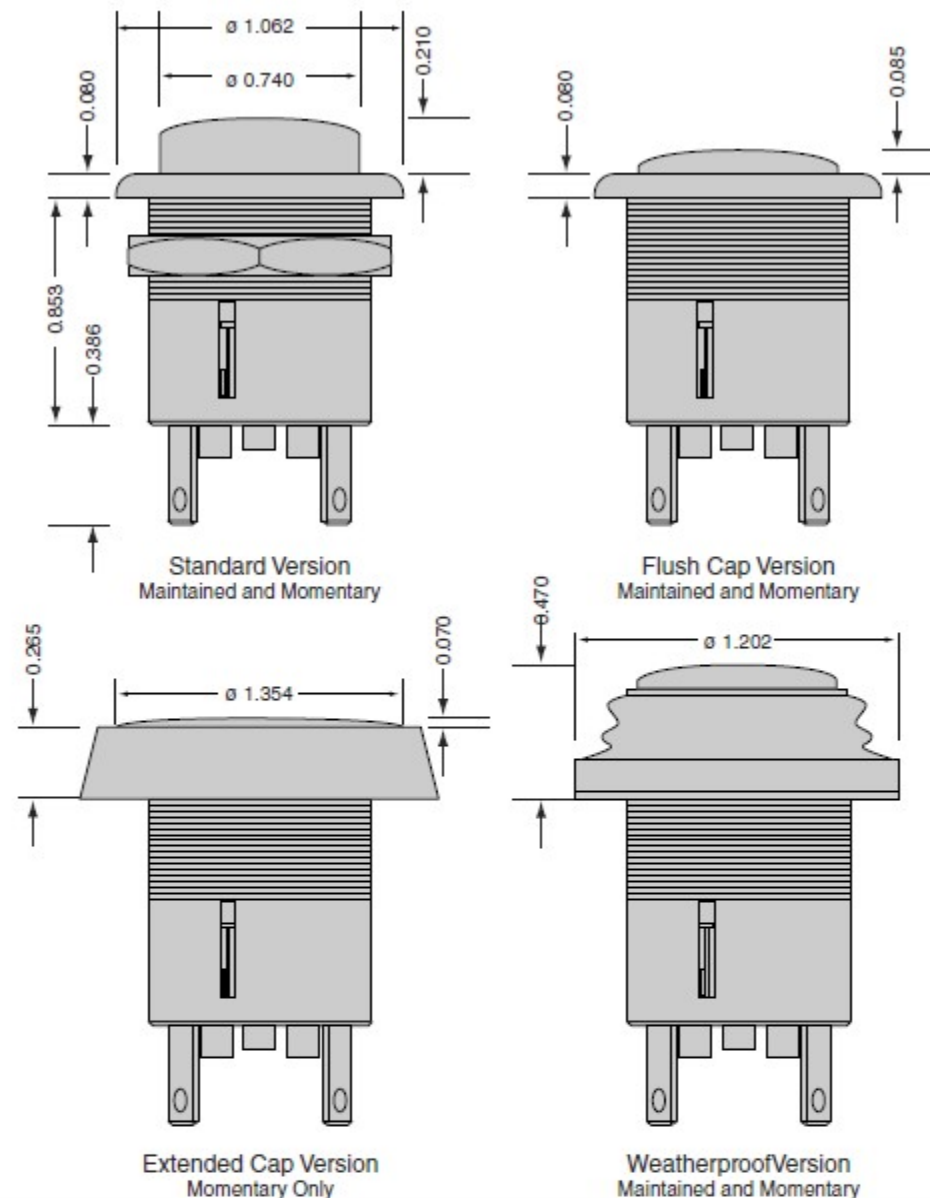

**Ordering Information:**

<b>M</b>	□	□	□	□	□	□	□	□
<b>Style</b>	<b>Illumination</b>	<b>Action</b>	<b>Circuit</b>	<b>Terminal</b>	<b>Lamp or LED Voltage</b>	<b>Lens</b>	<b>Body</b>	
S=Standard F=Flush W=Weatherproof E=Extended	L=Lighted P=Non-Lighted	A=Alternate M=Momentary G=Indicator Only	1=SPST 3=DPST 6=SPST with Lamp 7=DPST with Lamp 0=Indicator Only	B=3/16" Quick Connect G=Gold Plated	6V=6 Volt Incandescent 12V=12 Volt Incandescent 28V=28 Volt Incandescent 125V= 125 Volt Neon 125VG=125 Volt Green Neon 250V=250 Volt Neon 250VG=250 Volt Green Neon 2VR=2 Volt Red LED 2VG=2 Volt Green LED 2VA=2 Volt Amber LED 6VR=6 Volt Red LED 6VG=6 Volt Green LED 6VA=6 Volt Amber LED 12VR=12 Volt Red LED 12VG=12 Volt Green LED 12VA=12 Volt Amber LED	1=Red 2=Clear 3=Amber 4=Green 5=Blue 6=Translucent 7=Opaque White 9=Opaque Black 12=Opaque Red	Matte Finish M9=Black (For other colors contact factory)	